

"EXHIBIT A"

VOL 1187 PAGE 106

NOTE: THIS IS A SCALED DOWN DRAWING OF A WATER DISTRIBUTION SYSTEM CONSTRUCTED FOR WILLIAM GALLMAN. THIS DRAWING IS FOR ASSISTING IN TRANSFERRING OWNERSHIP OF THE WATER SYSTEM FROM MR. GALLMAN TO THE RABON CREEK RURAL WATER DISTRICT.

Ref.: Plat of William G. Gallman by J.L. Montgomery, III August 1982

Note: This system is located appx. 1.5 mi. North of the Laurens County Line on Fairview Road near Woods Drive

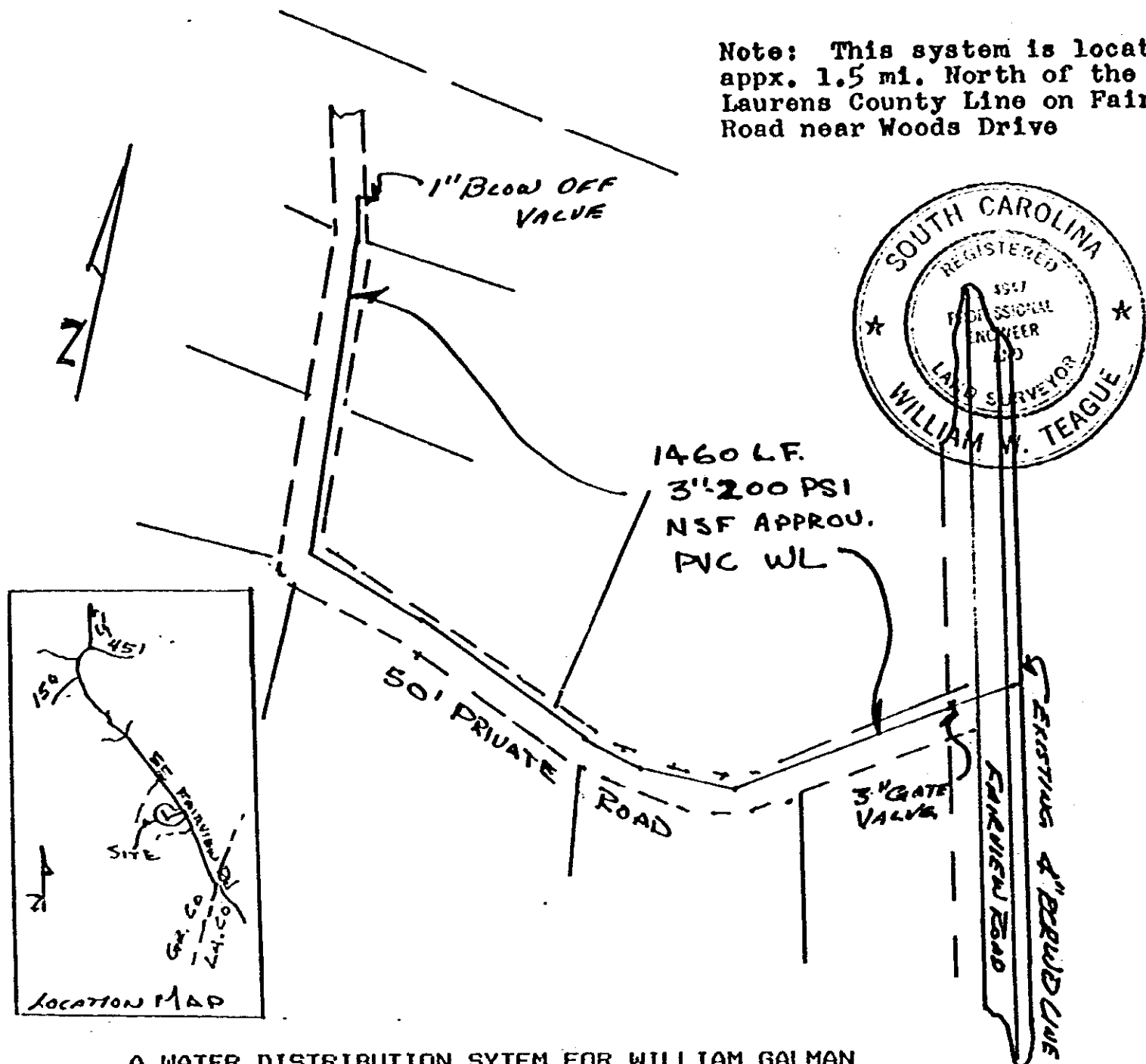

A WATER DISTRIBUTION SYTEM FOR WILLIAM GALMAN LOCATED OFF FAIRVIEW ROAD.

GREENVILLE COUNTY SOUTH CAROLINA

TEAGUE ENGINEERING COMPANY
LAURENS, S. C.

SCALE: 1"=200'
DATE: 2/25/83
JOB NO.: 8281

Attached to and made a part of Deed from Fair Stewart Gallman and William G. Gallman to Rabon Creek Rural Water District, dated April 29, 1983.

WITNESSES: Fair Stewart Gallman
Fair Stewart Gallman

Robert W. White
Robert W. White

Recorded April 26, 1983 at 12:00 P.M. 27989

106

1328